

BE brake repair kit

Sizes BE05 to BE30

SERVICE



BE brake repair kit

SEW-EURODRIVE offers the BE brake repair kit for service work to be performed by customers themselves on brakes of the BE series. It is available in nine versions for sizes BE05 to BE30 and is intended for installation in DR. motors.

The repair kit includes all parts required for preventative maintenance and repair of the respective brake type. The individual components are packed in a 100% recycled paperboard packaging, and are delivered together with a manual provided as hard copy and as CD. The CD contains the manual in the most common languages.

One repair kit – nine versions – available for 10 motor sizes



Types

Designation of the repair kit	For motor size(s)	Reference number
BE05A / BE1A	DR.71	17904005
BE05B / BE1B / BE1C	DR.80 and DR.90	17904013
BE2	DR.80, DR.90 and DR.100	17904021
BE5A	DR.90 and DR.100	17904048
BE5B	DR.112 and DR.132	17904056
BE11A	DR.112 and DR.132	17904064
BE11B	DR.160	17904072
BE20	DR.160 and DR.180	17904080
BE30	DR.180, DR.200 and DR.225	17904099

The marked parts are included in the BE brake repair kit

49 Pressure plate	67 Counter spring / setting sleeve
50 Brake spring / normal	68 Brake disk
61 Hex nut	69 Circular spring (not included in the kit for brake sizes BE05 to BE2)
63 Pole sheet (only included in the kit for brake sizes BE1 to BE11, depending on the braking torque)	73 Stainless steel washer (only included in the kit for brake sizes BE05 to BE2)
65 Pressure ring (not included in the kit for brake size BE30)	276 Brake spring / blue
66 Rubber sealing collar	718 Damping plate (only included in the kit for brake sizes BE05 to BE11)

Content of the respective BE20 brake repair kit

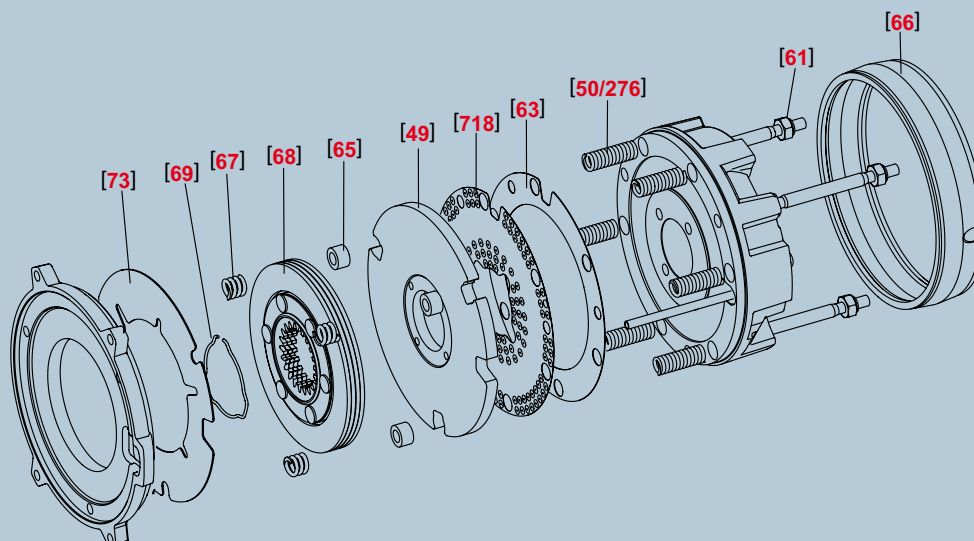

How we're driving the world



SEW-EURODRIVE
Driving the world