



GT2-H12K

Sensor Head, High-precision Type



*Please note that accessories depicted in the image are for illustrative purposes only and may not be included with the product.

Specifications

Model		GT2-H12K
Detection system		Quartz glass scale, CMOS image sensor projection system, Absolute type (without tracking error)
Measuring range		12 mm 0.47"
Resolution		0.1 μm 0.004 Mil
Indicated accuracy		1 μm 0.04 Mil (p-p)*1
Measuring force	Downward mounting	1.0 N*2
	Side mounting	0.9 N*2
	Upward mounting	0.8 N*2
Sampling cycle		1 ms
Mechanical response		10 Hz*1
Operation indicator light		2-color LED (red, green)
Environmental resistance	Enclosure rating	IP67
	Ambient temperature	-10 to +55 °C 14 to 131 °F (No freezing)
	Relative humidity	35 to 85 % RH (No condensation)
	Vibration resistance	10 to 55 Hz, Double amplitude 1.5 mm 0.06", 2 hours in each of the X, Y, and Z directions
	Shock resistance	1,000 m/s ² (IEC60068-2-27)
Materials	Main body	Main body cast: Zinc die-casting, Indicator: Polyarylate, Dust boot: NBR
	Dust boot	NBR
	Contact	TYPE304 Stainless steel, super-tough tungsten alloy*3
Sensor head cable		Optional (connect to the M8 connector)
Weight		Approx. 95 g (excluding cable)

*1 Value when the ambient temperature is 20 °C 68 °F.
*2 Value at center of measuring range. Please note that the measurement force changes depending on the installation state of the dust boots.
*3 The contact is included with the sensor.

Dimensions

* Download CAD file or product manual for larger image/text and more detail.

■ GT2-H12K(L)/H12(L)

When GT2-CH2M/5M/10M/20M is mounted

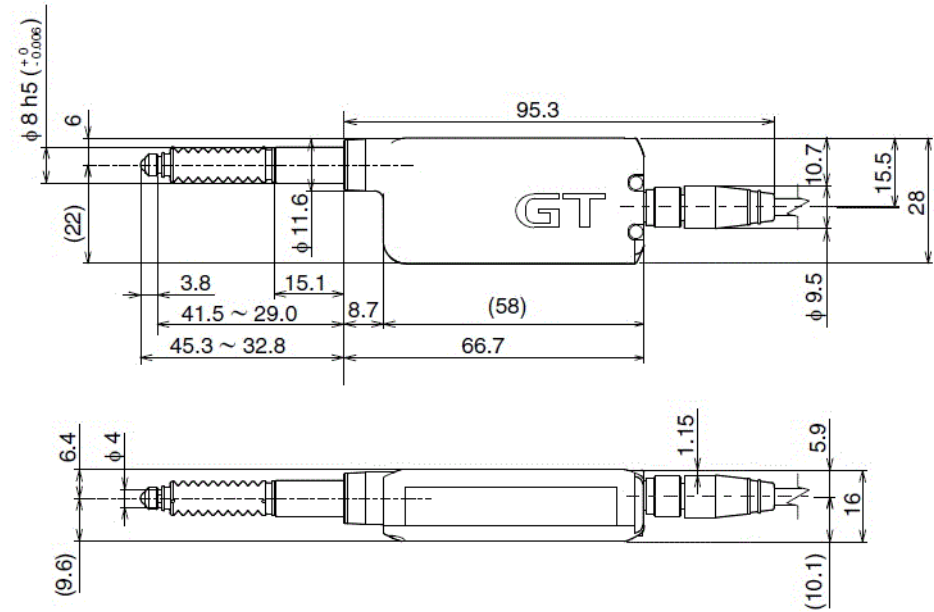

Unit: mm

When GT2-CHL2M/5M/10M/20M is mounted

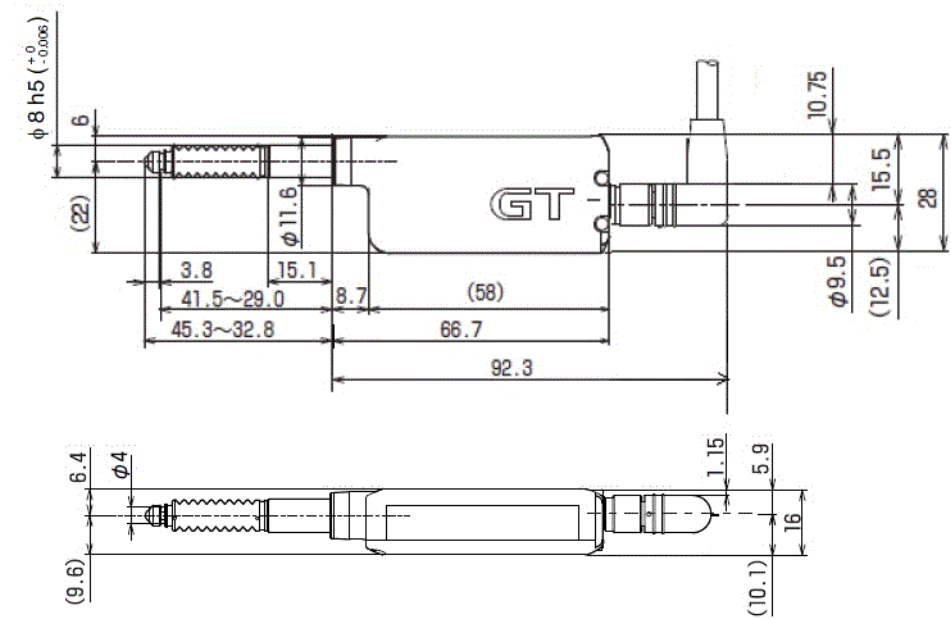

Unit: mm

Reference

There is no dust boot for GT2-H12KL/H12L.